

## OHDM 16P5002/S14

Diffuse sensors with background suppression - standard

Article number: 10238243

### Overview

- background suppression
- 25 ... 300 mm
- pulsed red laser diode
- PNP
- mechanical, 8 turn
- connector M12 4 pin
- 10 ... 50 °C
- IP 67



Picture similar



### Technical data

#### General data

Type	Background suppression
Light source	Pulsed red laser diode
Sensing distance Tw	25 ... 300 mm
Sensing range Tb (at Tw max.)	40 ... 300 mm
Sensing range Tb (at Tw min.)	5 ... 25 mm
Repeat accuracy	< 0.1 mm at laser focus
Output indicator	LED yellow
Sensing distance adjustment	Mechanical, 8 turn
Laser class	2
Distance to focus	40 mm
Wave length	650 nm
Suppression of reciprocal influence	Yes

#### Electrical data

Response time / release time	< 0.6 ms
Voltage supply range +Vs	10 ... 30 VDC

#### Electrical data

Current consumption max. (no load)	35 mA
Current consumption typ.	25 mA
Voltage drop Vd	< 2 VDC
Output function	Light / dark operate
Output circuit	PNP
Output current	< 200 mA
Short circuit protection	Yes
Reverse polarity protection	Yes

#### Mechanical data

Width / diameter	15.4 mm
Height / length	50 mm
Depth	50 mm
Type	Rectangular
Housing material	Die-cast zinc
Front (optics)	Glass
Connection types	Connector M12 4 pin

#### Ambient conditions

Protection class	IP 67
Operating temperature	-10 ... +50 °C

## OHDM 16P5002/S14

Diffuse sensors with background suppression - standard

Article number: 10238243

### Dimension drawing

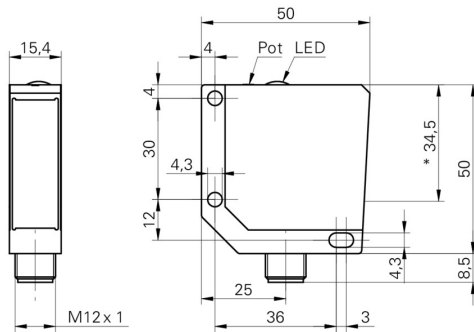

- \* emitter axis

### Laser warning

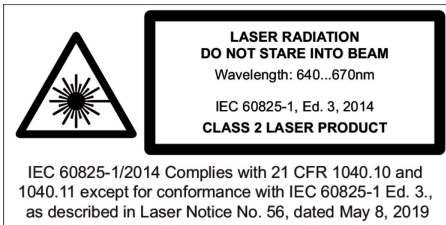

### Connection diagram

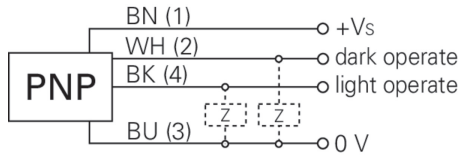

### Beam characteristic (typically)

