

2x torque arms, 3-armed (mounting kit 020)

Bolt circle $\varnothing 76$ mm, mounting M3

Article number: 11104313

Overview

- 2 torque arms, 3-armed, bolt circle $\varnothing 76$ mm, mounting M3
- For high-dynamic applications.



Technical data

Technical data - mechanical design

Weight approx. 20 g

Description

Torque supports mount onto encoder by help of the attached screws. The encoder slide onto the drive shaft and torque supports attach onto the client side. Fastening clamping ring with clamping ring screw.

Scope of delivery

2x torque support, three screws M3 x 6 (DIN 7985 - TX10)

Dimensions

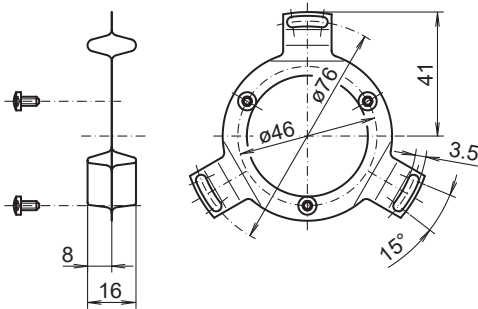

Assembly drawing

