

**Overview**

- 40 mm
- LED red / green / blue
- PNP
- -10 ... 55 °C
- IP 67



Picture similar



**Technical data**

General data		Electrical data	
Sensing distance Tw	40 mm	Output current (per channel)	< 100 mA
Sensor channels	4 (teachable)	Remote Teach-In input	Protocol with return signal through channel 1-output
Tolerance ranges	5-step teachable (LEDs)	Sync. input	Low active
Size of measuring spot	3 mm x 5 mm	Level (sync., teach)	high: 2/3 Vs...Vs low: 0 V...1/3 Vs
Light source	LED red / green / blue	Short circuit protection	Yes
Signal display (Teach)	LED orange	Reverse polarity protection	Yes
Channel status display	LED yellow per channel	Mechanical data	
Power on indication	LED green	Width / diameter	22.9 mm
Electrical data		Type	Rectangular
Response time / release time	< 0.34 ms	Housing material	Die-cast zinc
Voltage supply range +Vs	10 ... 30 VDC	Front (optics)	Glass
Power consumption	< 2 W	Device plug	Connector M12, 8 pin, rotatable
Output circuit	PNP	Ambient conditions	
Output function	Light operate	Operating temperature	-10 ... +55 °C
Voltage drop Vd	< 1.8 VDC	Protection class	IP 67

2022-11-10 The product features and technical data specified do not express or imply any warranty. Technical modifications subject to change.

**Dimension drawing**

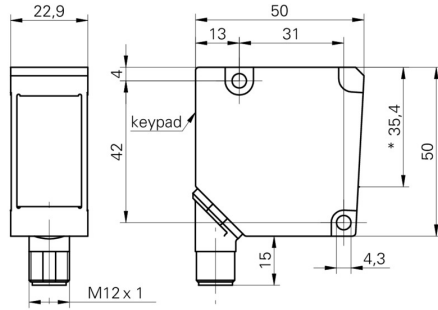

- \* emitter axis

**Connection diagram**

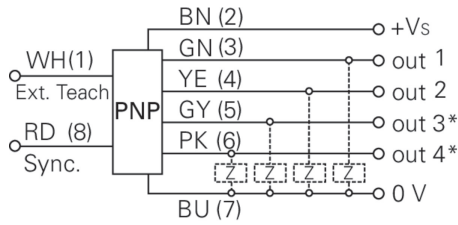

\* only in the 4-channel version