

Overview

- 0 ... 120 mm
- pulsed red laser diode
- push-pull
- 50 °C
- IP 54



Technical data

General data

Measuring distance Sd	0 ... 120 mm
Optimum operating distance	100 mm
Counting rate	< 600000 Copies/h
Object speed	< 5 m/sec
Sensitivity	Single sheet/edge thickness 0,25 mm
Sync. input	No
Measuring point	Visible red laser line 3 mm
Light source	Pulsed red laser diode
Wave length	670 nm
Laser class	2
Edge indicator	LED yellow
Power on indication	LED green
False pulse suppression	On/off switchable

Electrical data

Voltage supply range +Vs	10 ... 30 VDC
--------------------------	---------------

Electrical data

Current consumption max. (no load)	180 mA
Output circuit	Push-pull
Output pulse length	5 / 10 ms selectable
Short circuit protection	Yes
Reverse polarity protection	Yes

Mechanical data

Width / diameter	30 mm
Type	Rectangular
Housing material	PA 6
Connector base (main connector)	M12 x 1, 5 pin
Front (optics)	Glass

Ambient conditions

Operating temperature	0 ... +50 °C
Protection class	IP 54

Dimension drawing

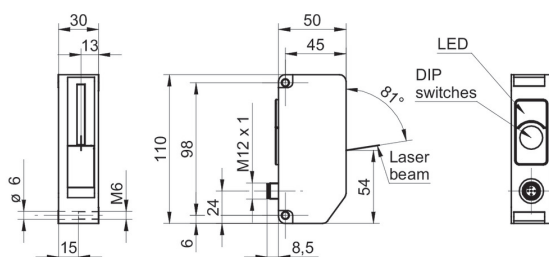

Laser warning



LASER RADIATION
DO NOT STARE INTO BEAM
Wavelength: 640...670nm
IEC 60825-1, Ed. 3, 2014
CLASS 2 LASER PRODUCT

IEC 60825-1/2014 Complies with 21 CFR 1040.10 and 1040.11 except for conformance with IEC 60825-1 Ed. 3., as described in Laser Notice No. 56, dated May 8, 2019

FLDK 110G1006/S14

Copy counters - packaging

Article number: 11040147

Connection diagram

