

Overview

- Large measuring range from 0...10 mm
- Analog output and additional switching output
- Easy commissioning due to linearized output signal
- Application specific adjustment by qTeach
- Robust plastic housing usable up to +75°C



Picture similar



Technical data

General data		Electrical data	
Mounting type	Non-flush	Output circuit	Voltage output / PNP
Special type	Linearized	Output signal	0 ... 10 VDC
Measuring distance Sd	0 ... 10 mm	Load resistance	> 10 kOhm
Resolution	< 0.013 mm (stat.)	Output current	< 100 mA
Repeat accuracy	0.013 mm	Voltage drop Vd	< 2.5 VDC
Adjustment	qTeach	Short circuit protection	Yes
Teach	Single point, Window	Reverse polarity protection	Yes
Linearity error	± 50 µm	Mechanical data	
Temperature drift	± 2 % (Full Scale)	Type	Rectangular
Power on indication	LED green	Housing material	SAN
Output indicator	LED yellow	Dimension	20 mm
Electrical data		Housing length	41 mm
Response time (factory characteristic)	< 1 ms	Connection types	Cable PVC, 2 m
Voltage supply range +Vs	12 ... 30 VDC	Ambient conditions	
Current consumption max. (no load)	25 mA	Operating temperature	-25 ... +75 °C
		Protection class	IP 67

2023-01-31 The product features and technical data specified do not express or imply any warranty. Technical modifications subject to change.

Dimension drawing

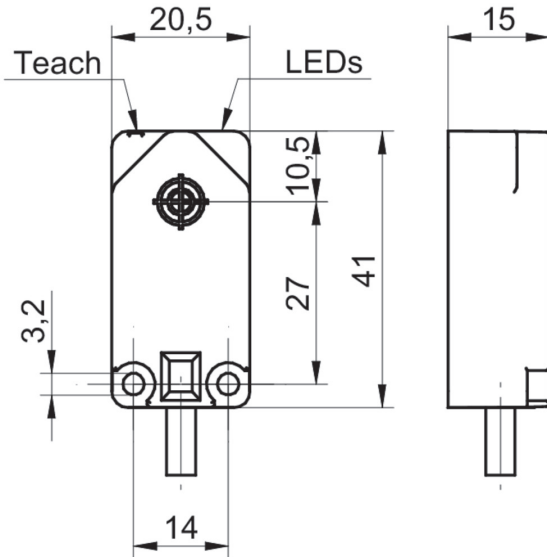

Connection diagram

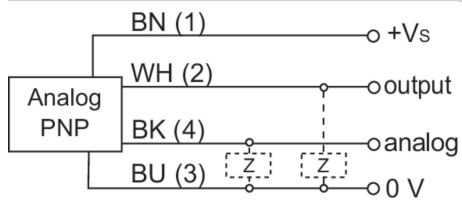

Resolution

