

Overview

- Large measuring range from 0...10 mm
- Analog output and additional switching output
- Easy commissioning due to linearized output signal
- Application specific adjustment by qTeach
- Robust plastic housing usable up to +75°C



Picture similar

Technical data

General data		Electrical data	
Mounting type	Non-flush	Output circuit	Voltage output / PNP
Special type	Linearized	Output signal	0 ... 10 VDC
Type	Distance measuring	Load resistance	> 10 kOhm
Measuring distance Sd	0 ... 10 mm	Output current	< 100 mA
Resolution	< 0.013 mm (stat.)	Voltage drop Vd	< 2.5 VDC
Repeat accuracy	0.013 mm	Short circuit protection	Yes
Adjustment	qTeach	Reverse polarity protection	Yes
Teach	Single point, Window	Mechanical data	
Linearity error	< 50 µm	Type	Rectangular
Temperature drift	± 2 % (Full Scale)	Housing material	SAN
Power on indication	LED green	Dimension	20 mm
Output indicator	LED yellow	Housing length	41 mm
Electrical data		Connection types	Connector M8
Response time (factory characteristic)	< 1 ms	Ambient conditions	
Voltage supply range +Vs	12 ... 30 VDC	Operating temperature	-25 ... +75 °C
Current consumption max. (no load)	25 mA	Protection class	IP 67

2023-01-31 The product features and technical data specified do not express or imply any warranty. Technical modifications subject to change.

Dimension drawing

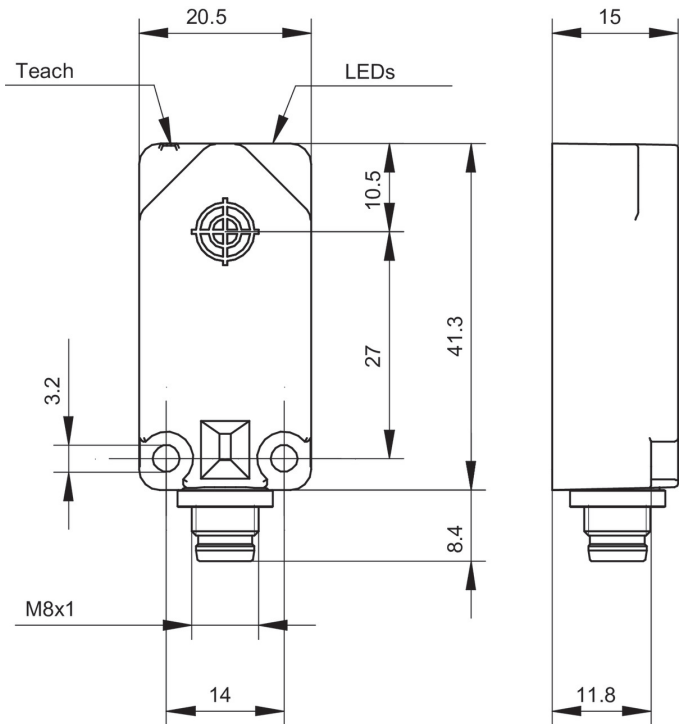

Resolution

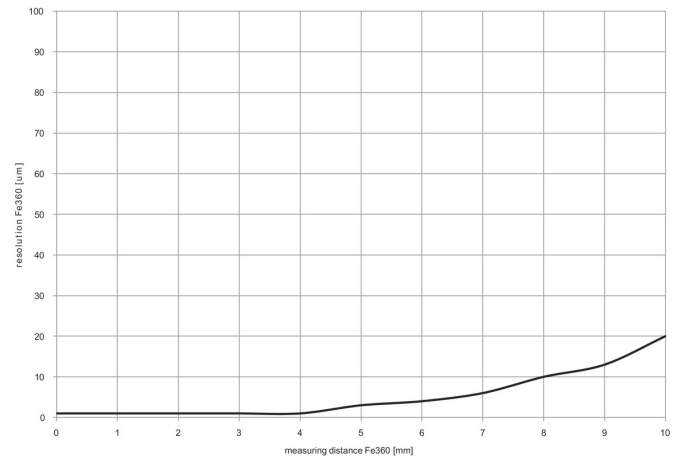

Connection diagram

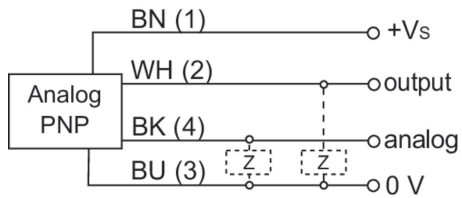

Pin assignment

