

Overview

- 1,5 mm
- NAMUR
- cable, 2 m
- -25 ... 75 °C
- IP 67



Picture similar



Technical data

General data

Mounting type	Flush
Nominal sensing distance	1.5 mm
Sn	

Electrical data

Switching frequency	5 kHz
Normal operating voltage	8.2 VDC
Voltage supply range +Vs	5 ... 30 VDC
Current consumption un-damped	> 4 mA
Current consumption damped	< 1 mA
Current consumption max. (no load)	10 mA

Electrical data

Output circuit	NAMUR
Residual ripple	< 10 % Vs

Mechanical data

Design	Rectangular
Material (sensing face)	PBT
Housing material	Brass nickel plated
Dimension	8 mm
Housing length	25 mm
Connection types	Cable, L=2 m

Ambient conditions

Operating temperature	-25 ... +75 °C
Protection class	IP 67

IFF 08.82.05

Inductive sensors NAMUR

Article number: 10250306

Dimension drawing

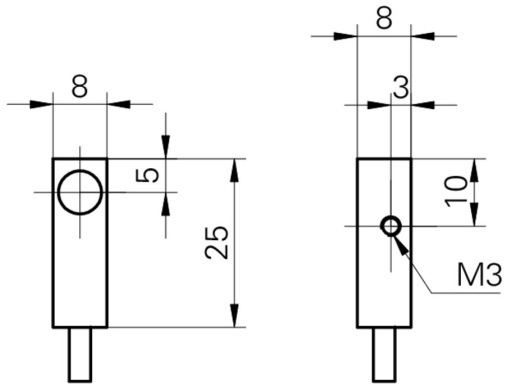

Connection diagram

