

O200.GR.F-GW1J.72CV/E026_H006

Diffuse sensors with background suppression - miniature

Article number: 11210568

Overview

- Outstanding reliability and unrivalled immunity against ambient light
- V-optics for detection of shiny or transparent objects
- Manipulation-proof, simple teach-in via qTeach or line teach
- IO-Link for extended parameterization options and additional diagnostic data
- Quick mounting by means of M3 threaded bushes made of stainless steel



Picture similar



Technical data

General data		Electrical data	
Type	Background suppression	Voltage drop Vd	<2 VDC
Version	Fixed focus	Output function	Light / dark operate
Sensing distance Tw	8 ... 13.5 mm	Output circuit	Push-pull
Sensing range Tb	3 ... 15 mm	Output current	50 mA
Smallest object recognizable typ.	0.05 mm at 10 mm	Short circuit protection	Yes
Power on indication	LED green	Reverse polarity protection	Yes
Alignment / soiled lens indicator	Flashing output indicator	Communication interface	
Output indicator	LED yellow	Interface	IO-Link V1.1
Sensing distance adjustment	Teach-in and IO-Link	IO-Link port type	Class A
Suppression of reciprocal influence	Yes	Baud rate	230,4 kBaud (COM 3)
Alignment optical axis	< 1,5°	Cycle time	≥ 0.6 ms
Light Source		Process data length	32 Bit
Light source	Pulsed red LED	Process data structure	Bit 0 = SSC1 (presence) Bit 2 = quality Bit 3 = alarm Bit 5 = SSC4 (counter) Bit 16-31 = 16 Bit measurement
Wave length	644 nm	Adjustable parameters	Switching point Switching hysteresis Time filters LED status indicators Output logic Counter Operation mode Deactivate the sensor element Find Me function Teach-in mode
Electrical data			
Response time / release time	< 0.25 ms (High Speed Mode)		
Voltage supply range +Vs	10 ... 30 VDC		
Current consumption max. (no load)	40 mA (@ 10 VDC)		
Current consumption typ.	16 mA (@ 24 VDC)		

O200.GR.F-GW1J.72CV/E026_H006

Diffuse sensors with background suppression - miniature

Article number: 11210568

Technical data

Communication interface

Additional data	Excess gain
	Operating cycles
	Device temperature

Mechanical data

Width / diameter	8 mm
Height / length	25.1 mm
Depth	14.1 mm
Design	Rectangular
Mechanical mounting	Threaded sleeves M3 (stainless steel)

Mechanical data

Housing material	Plastic (ASA, PMMA)
Front (optics)	PMMA
Connection types	Cable 4 pin, 2 m
Cable characteristics	PVC / PVC 4 x 0.08 mm ²

Ambient conditions

Protection class	IP 67
Operating temperature	-25 ... +50 °C

Remarks

- qTeach

Dimension drawing

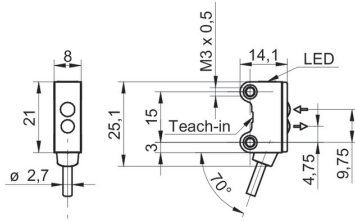

Sensing distance diagram

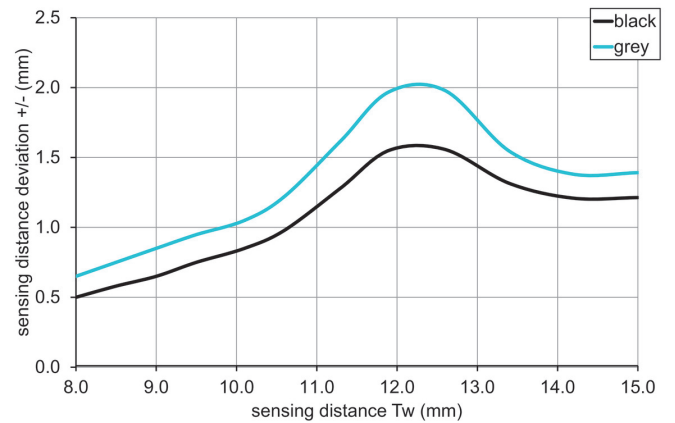

Connection diagram

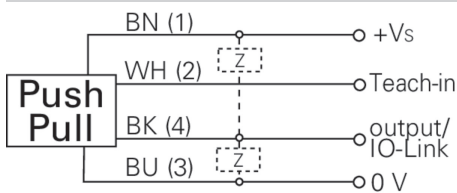

Beam characteristic (typically)

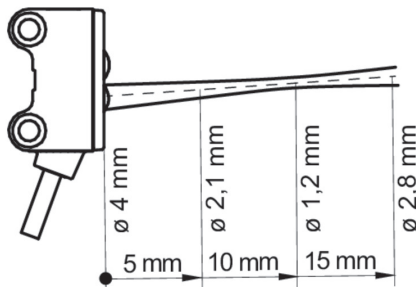

Hysteresis curve

