

**Overview**

- SmartReflect - Safe barrier principle without reflector
- Baumer PinPoint LED: Small, homogeneous light spot with sharp edges
- Manipulation-proof, simple teach-in via qTeach or line teach
- IO-Link for extended parameterization options and additional diagnostic data
- Robust housing with stainless steel spacer sleeves



Picture similar



**Technical data**

General data		Electrical data	
Type	Light barrier	Output function	Light / dark operate
Version	Standard object detection	Output circuit	Push-pull
Light source	Pulsed PinPoint LED	Output current	< 50 mA
Background position Sde	25 ... 180 mm	Short circuit protection	Yes
Scanning range Sa	90% ... 85% Sde	Reverse polarity protection	Yes
Smallest object recognizable typ.	2,5 mm	<b>Communication interface</b>	
Alignment / soiled lens indicator	Flashing output indicator	Baud rate	230,4 kBaud (COM 3)
Power on indication	LED green	Adjustable parameters	Switching point Time filters LED status indicators Output logic Counter Operation mode Deactivate the sensor element Find Me function Teach-in mode
Output indicator	LED yellow	IO-Link port type	Class A
Sensing distance adjustment	Teach-in and IO-Link	Process data length	32 Bit
Wave length	644 nm	Process data structure	Bit 0 = SSC1 (presence) Bit 2 = quality Bit 3 = alarm Bit 5 = SSC4 (counter) Bit 16-31 = 16 Bit measurement
Suppression of reciprocal influence	Yes	Interface	IO-Link V1.1
Alignment optical axis	< 1,5°	Additional data	Excess gain Operating cycles Device temperature
<b>Electrical data</b>			
Response time / release time	< 0,25 ms (High Speed Mode)		
Voltage supply range +Vs	10 ... 30 VDC		
Current consumption max. (no load)	40 mA (@ 10 VDC)		
Current consumption typ.	16 mA (@ 24 VDC)		
Voltage drop Vd	< 2 VDC		

2021-05-06 The product features and technical data specified do not express or imply any warranty. Technical modifications subject to change.

# O200.SP-GW1J.72CV

SmartReflect Light barriers - miniature

Article number: 11210554

## Technical data

### Communication interface

Cycle time  $\geq 0,6$  ms

### Mechanical data

Width / diameter 8 mm

Height / length 25,1 mm

Depth 15,8 mm

Type Rectangular

Mechanical mounting Sleeve smooth (stainless steel)

### Mechanical data

Housing material Plastic (ASA, PMMA)

Front (optics) PMMA

Connection types Cable 4 pin, 2 m

Cable characteristics PVC / PVC 4 x 0,08 mm<sup>2</sup>

### Ambient conditions

Protection class IP 67

Operating temperature -25 ... +50 °C

## Remarks

- qTeach

## Dimension drawing

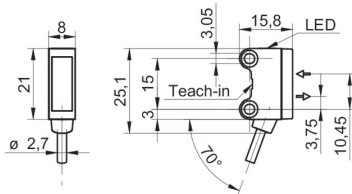

## Connection diagram

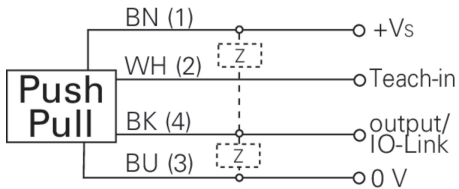

## Beam characteristic (typically)

