

Overview

- through beam sensor
- 50 mm
- pulsed red laser diode
- PNP
- potentiometer, 270°
- connector M8, 3 pin
- 5 ... 45 °C
- IP 67

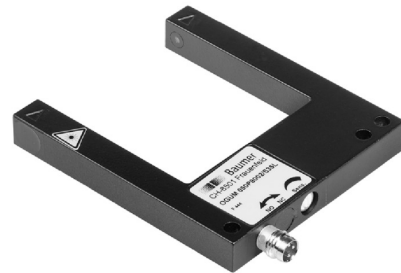

Picture similar



Technical data

General data

Type	Through beam sensor
Object size	> 0,1 mm
Repeat accuracy	< 0,02 mm
Response time / release time	< 0,166 ms
Hysteresis	< 0,05 mm
Ambient light immunity	< 5 kLux
Sensitivity adjustment	Potentiometer, 270°
Light source	Pulsed red laser diode
Wave length	670 nm
Laser class	1
Light indicator	LED yellow

Electrical data

Switching frequency	< 3 kHz
Voltage supply range +Vs	10 ... 30 VDC
Current consumption max. (no load)	30 mA
Output function	Light / dark operate switchable

Electrical data

Output circuit	PNP
Voltage drop Vd	< 2,8 VDC
Output current	< 200 mA
Short circuit protection	Yes
Reverse polarity protection	Yes

Mechanical data

Width / diameter	70 mm
Fork width Sb	50 mm
Height / length	80 mm
Penetration depth	55 mm
Depth	10 mm
Type	U profile
Housing material	Die-cast zinc
Connection types	Connector M8, 3 pin

Ambient conditions

Operating temperature	5 ... +45 °C
Protection class	IP 67

Remarks

- Accessories: PNP/NPN - converter

Dimension drawing

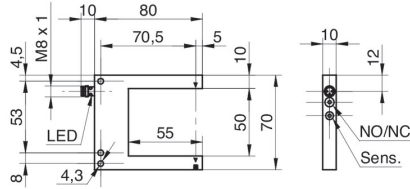

Laser warning

**CLASS 1 LASER
PRODUCT**

IEC 60825-1/2014

Complies with 21 CFR 1040.10 and 1040.11 except for conformance with IEC 60825-1 Ed. 3., as described in Laser Notice No. 56, dated May 8, 2019

Connection diagram

