

## OPDM 12P5103/S35A

Retro-reflective sensors - miniature

Article number: 10137861

### Overview

- retro-reflective laser sensor
- 7 m
- pulsed red laser diode
- PNP
- no
- connector M8 4 pin
- -10 ... 50 °C
- IP 67



Picture similar



### Technical data

General data		Electrical data	
Type	Retro-reflective laser sensor	Current consumption typ.	40 mA
Version	Single lens optics	Voltage drop Vd	< 1,8 VDC
Light source	Pulsed red laser diode	Output function	Light / dark operate
Actual range Sb	7 m	Output circuit	PNP
Nominal range Sn	8 m	Output current	< 100 mA
Repeat accuracy	< 0,1 mm at laser focus	Short circuit protection	Yes
Polarization filter	Yes	Reverse polarity protection	Yes
Alignment / soiled lens indicator	Flashing light indicator	Mechanical data	
Light indicator	LED yellow	Width / diameter	12,4 mm
Power on indication	LED green	Height / length	35 mm
Sensitivity adjustment	No	Depth	35 mm
Laser class	2	Type	Rectangular
Distance to focus	Parallel beam	Housing material	Die-cast zinc
Wave length	650 nm	Front (optics)	Glass
Electrical data		Connection types	Connector M8 4 pin
Response time / release time	< 0,1 ms	Ambient conditions	
Voltage supply range +Vs	10 ... 30 VDC	Operating temperature	-10 ... +50 °C
Current consumption max. (no load)	50 mA	Protection class	IP 67

# OPDM 12P5103/S35A

Retro-reflective sensors - miniature

Article number: 10137861

## Dimension drawing

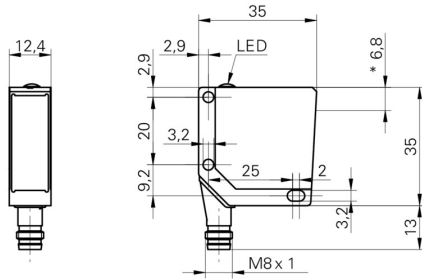

## Connection diagram

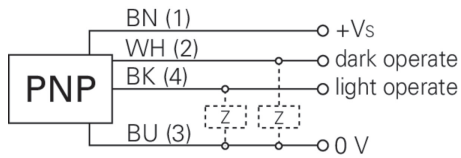

## Laser warning



**LASER RADIATION**  
**DO NOT STARE INTO BEAM**  
Wavelength: 640...670nm

IEC 60825-1, Ed. 3, 2014  
**CLASS 2 LASER PRODUCT**

IEC 60825-1/2014 Complies with 21 CFR 1040.10 and 1040.11 except for conformance with IEC 60825-1 Ed. 3., as described in Laser Notice No. 56, dated May 8, 2019

## Beam characteristic (typically)

