

## TE2

Compact RTD temperature sensor

TE2-#.###.###.0

### Overview

- Compact and rugged design
- Customer-specific immersion depth down to 3000 mm
- Precision measurement from -50 ... 250 °C
- Integrated 4 ... 20 mA transmitter or Pt100 output
- Easy process implementation from DN 25 or in tank



### Technical data

#### Performance characteristics

Pt100 accuracy class (EN 60751)	B ( $\pm 0.3\text{ °C at }0\text{ °C}$ ) $\pm (0.3 + 0.005 \times t)\text{ °C}$ A ( $\pm 0.15\text{ °C at }0\text{ °C}$ ) $\pm (0.15 + 0.002 \times t)\text{ °C}$ 1/3 B ( $\pm 0.1\text{ °C at }0\text{ °C}$ ) $\pm 1/3 \times (0.3 + 0.005 \times t)\text{ °C}$ 1/6 B ( $\pm 0.05\text{ °C at }0\text{ °C}$ ) $\pm 1/6 \times (0.3 + 0.005 \times t)\text{ °C}$
---------------------------------	---

Thermal response time, T50	RTD element only $\leq 1.0\text{ s}$ , conical sensor $\leq 1.3\text{ s}$ , Ø3 mm $\leq 2.5\text{ s}$ , Ø4 mm $\leq 3.0\text{ s}$ , Ø6 mm
----------------------------	---

Thermal response time, T90	RTD element only $\leq 3.0\text{ s}$ , Ø3 mm $\leq 3.6\text{ s}$ , Ø4 mm $\leq 8.5\text{ s}$ , Ø6 mm
----------------------------	---

Process pressure	Refer to section "Operating conditions"
------------------	---

Process temperature	Refer to section "Operating conditions"
---------------------	---

#### Process connection

Connection variants	Refer to section "Dimensional drawings"
Sensor length	$\leq 3000\text{ mm}$
Sensor diameter outside	Ø 6 mm
Mounting position	Any, top, bottom, side
Standard response tip	Ø 6 mm
Fast response tip	Ø 3 mm Ø 4 mm
Sensor tube material	AISI 316L (1.4404)
Surface roughness wetted parts	Ra $\leq 0.8\text{ µm}$

#### Ambient conditions

Operating temperature range	-40 ... 125 °C, with Pt100 -40 ... 85 °C, with transmitter
-----------------------------	---

#### Ambient conditions

Storage temperature range	-55 ... 90 °C
Degree of protection (EN 60529)	IP 65, with DIN EN 175301-803 A (DIN 43650 A), 4-pin IP 67, with M12-A, 4-pin
Humidity	$\leq 100\%$ RH, condensing
Long-term test (transmitter)	IEC 770 6.3.2
Vibration (sinusoidal) (EN 60068-2-6)	1.6 mm p-p (2 ... 25 Hz), 4 g (25 ... 100 Hz), 1 octave / min.

#### Output signal

Without transmitter	1 x Pt100, 4-wire
With transmitter	4 ... 20 mA, 2-wire

#### Housing

Style	Compact transmitter
Overall size	Refer to section "Dimensional drawings"
Material	AISI 304 (1.4301)

#### Electrical connection

Connector	DIN EN 175301-803 A (DIN 43650 A), 4-pin M12-A, 4-pin
-----------	--

#### Power supply

Voltage supply range	8 ... 35 V DC
Power-up time	< 20 s
Reverse polarity protection	Yes

#### Factory settings

Output range	0 ... 150 °C
Damping	0 s
Output at sensor fault	23 mA

#### Compliance and approvals

EMC	EN 61000-6-2 EN 61000-6-3 EN 61326-1 NE21
-----	--

## TE2

Compact RTD temperature sensor

TE2-#.###.####.####.0

### Technical data

#### Compliance and approvals

Hygiene	FDA (21 CFR 177.2415) 3-A (74-07)
Railway applications	EN 50155

#### Compliance and approvals

Explosion protection	Ex ia Simple apparatus, gas and dust
----------------------	--------------------------------------

### Transmitter

Input		Output	
Measuring unit	°C °F	Output signal	4 ... 20 mA , 2-wire
Min. measuring span	25 °C	Accuracy	< 0.1 % , measuring span < 0.016 mA
Sample time	< 0.7 s	Temperature drift	< 0.003 %/K , typ. < 0.01 %/K , max.
Accuracy	< 0.25 °C , @ ≤ 100 °C	Resolution	12 bit
Repeatability	< 0.1 °C	Effect of variations in supply voltage	< 0.01 %/V
Resolution	14 bit	Ripple immunity	3 Vrms
Ripple immunity	IEC 770 6.2.4.2	Shunt resistance	$R_s \leq (V_{DC} - 8 V)/0.023 A$
Error detection delay	< 10 s	Damping	0.0 ... 30.0 s , programmable
Offset adjustment	± 10 °C , max.	Up/Down scaling limits	23 mA / 3.5 mA
Isolation, sensor to case	50 V AC , test 500V		
Protection	± 35 V DC		
Suppression	50 Hz 60 Hz		

### Operating conditions

Ordering key	Process connection	BCID	Process pressure	Continuous Process temperature Standard @ Tamb ≤ 20 °C	Process temperature With cooling neck @ Tamb ≤ 20 °C
			(bar)	(° C)	(° C)
TE2-#.1.####.####.#	Sleeve Ø 6	T65	-1 ... 40	-50 ... 125	-50 ... 250
TE2-#.3.####.####.#	G 1/2 A ISO 228-1	G06	-1 ... 100	-50 ... 125	-50 ... 250
TE2-#.4.####.####.#	G 1/2 A hygienic	A03	-1 ... 40	-50 ... 125	-50 ... 250
TE2-#.5.####.####.#	M12 x 1.5 hygienic	A02	-1 ... 40	-50 ... 125	-50 ... 250
TE2-#.6.####.####.#	M12 x 1.5 hygienic, with PEEK cone	A02	-1 ... 10	-50 ... 115	N/A
TE2-#.7.####.####.#	G 1/8 female thread hygienic	A01	-1 ... 40	-50 ... 205	-50 ... 250
TE2-#.8.####.####.#	G 1/4 A DIN 3852-E	G50	-1 ... 100	-50 ... 125	-50 ... 250
TE2-#.9.####.####.#	ISO 2852 (Tri-Clamp), DN 33.7; 38, Ø 50.5	C04	-1 ... 40	-50 ... 125	-50 ... 250
TE2-#.A.####.####.#	Tri-Clamp Ø 24.9	C01	-1 ... 40	-50 ... 125	-50 ... 250
TE2-#.B.####.####.#	BHC 3A DN 38	B01	-1 ... 40	-50 ... 125	-50 ... 250
TE2-#.D.####.####.#	1/2-14 NPT	N02	-1 ... 100	-50 ... 125	-50 ... 250
TE2-#.E.####.####.#	1/4-18 NPT	N01	-1 ... 100	-50 ... 125	-50 ... 250
TE2-#.F.####.####.#	G 1/2 A DIN 3852-E	G51	-1 ... 100	-50 ... 125	-50 ... 250
TE2-#.G.####.####.#					

For further information on permissible process and ambient temperatures, please refer to the operating instructions.

## TE2

Compact RTD temperature sensor

TE2-#.###.####.0

### Compliance and approvals

Ordering key	Process connection	BCID	EN 10/2011	EN 1935/2004 EN 2023/2006	FDA	3-A
TE2-#.1.####.####.#	Sleeve Ø 6	T65				
TE2-#.3.####.####.#	G 1/2 A ISO 228-1	G06				
TE2-#.4.####.####.#	G 1/2 A hygienic	A03		■		
TE2-#.5.####.####.#	M12 x 1.5 hygienic	A02		■		
TE2-#.6.####.####.#	M12 x 1.5 hygienic, with PEEK cone	A02	■	■	■	
TE2-#.7.####.####.#	G 1/8 female thread hygienic	A01		■		
TE2-#.8.####.####.#	G 1/4 A DIN 3852-E	G50				
TE2-#.9.####.####.#	ISO 2852 (Tri-Clamp), DN 33.7; 38, Ø 50.5	C04		■		■
TE2-#.A.####.####.#	Tri-Clamp Ø 24.9	C01		■		
TE2-#.B.####.####.#	BHC 3A DN 38	B01		■		■
TE2-#.D.####.####.#	1/2-14 NPT	N02				
TE2-#.E.####.####.#	1/4-18 NPT	N01				
TE2-#.F.####.####.#						
TE2-#.G.####.####.#	G 1/2 A DIN 3852-E	G51				

The requirements of the respective 3-A Sanitary Standard will be only fulfilled in combination with appropriate mounting accessories. Those are marked with the 3-A logo.

### Dimensional drawings (mm)

#### Housing

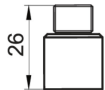

Housing with connector M12-A, 4-pin

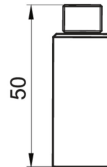

Housing with transmitter and connector M12-A, 4-pin

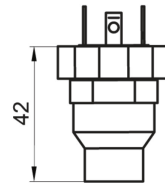

Housing with connector DIN EN 175301-803 A (DIN 43650 A), 4-pin

## TE2

Compact RTD temperature sensor

TE2-#. #. ####. ####. 0

### Dimensional drawings (mm)

#### Housing



Housing with transmitter and connector DIN  
EN 175301-803 A (DIN 43650 A), 4-pin

Cooling neck

#### Process connection

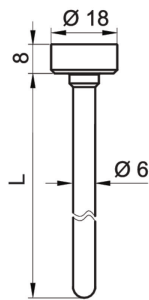

Without thread (BCID: T65)

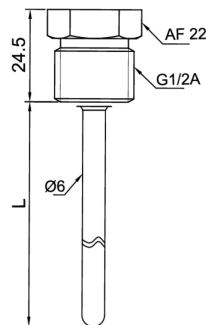

G 1/2 A ISO 228-1 (BCID: G06)

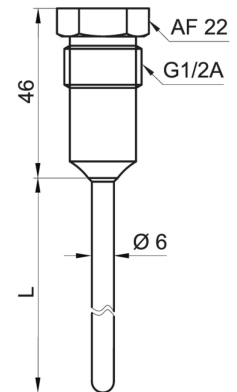

G 1/2 A hygienic (BCID: A03)

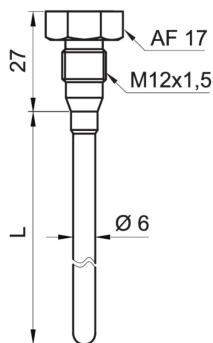

M12 × 1.5 hygienic (BCID: A02)

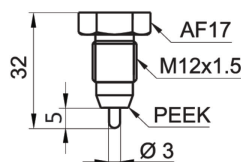

M12 × 1.5 hygienic, PEEK cone, tip Ø 3 x 5  
mm (BCID: A02)

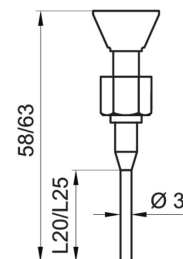

G 1/8 female thread hygienic (BCID: A01)

## TE2

Compact RTD temperature sensor

TE2-#. #.####.####.0

### Dimensional drawings (mm)

#### Process connection

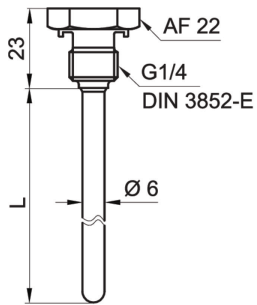

G 1/4 A DIN 3852-E (BCID: G50)

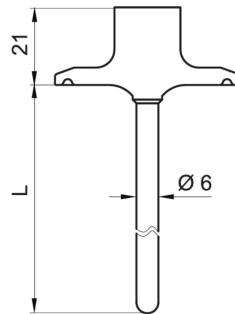

Tri-Clamp Ø 50.5 (BCID: C04)

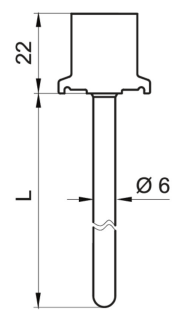

Tri-Clamp Ø 24.9 (BCID: C01)

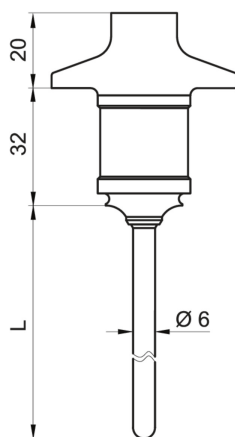

BHC 3A DN 38 (BCID: B01)

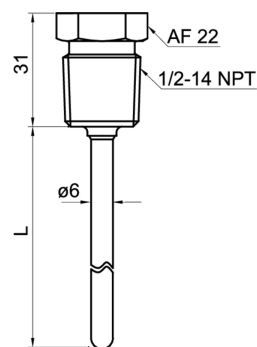

1/2-14 NPT (BCID: N02)

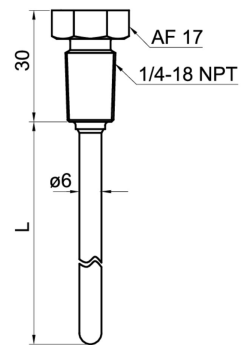

1/4-18 NPT (BCID: N01)

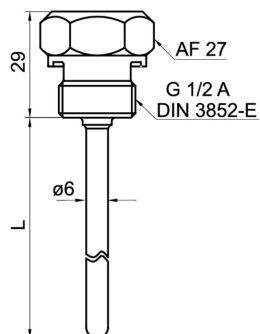

G 1/2 A DIN 3852-E (BCID: G51)



Standard response tip

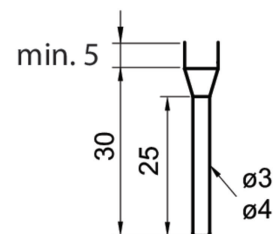

Fast response tip

## TE2

Compact RTD temperature sensor

TE2-#. #. #####. #####.0

### Electrical connection

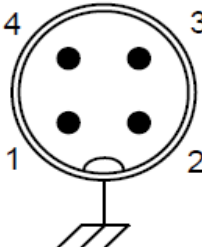
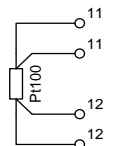
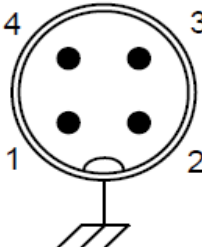
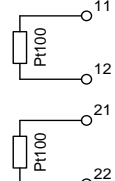
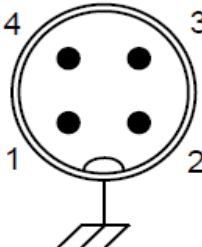
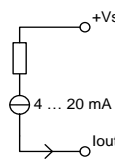
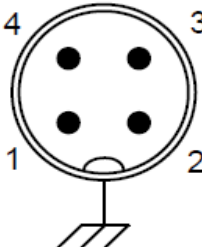
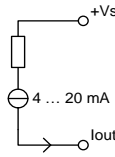
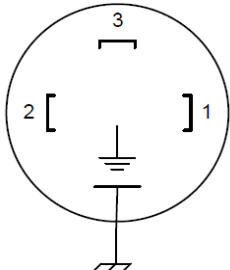
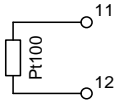
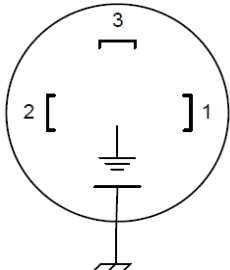
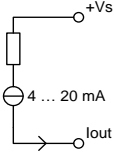
Output type	Electrical connection	Equivalent circuit	Function	Pin assignment
M12-A, 4-pin, stainless steel				
Pt100 (Single element)			Pt100 11	1, 2
			Pt100 12	3, 4
			Frame ground	Plug thread
Pt100 (Double element)			Pt100 11	1
			Pt100 12	4
			Pt100 21	2
			Pt100 22	3
4 ... 20 mA, 2-wire, Iout at pin 2			+Vs	1
			Iout	2
			N.C.	3, 4
			Frame ground	Plug thread
4 ... 20 mA, 2-wire, Iout at pin 2, 3			+Vs	1
			Iout	2, 3
			N.C.	4
			Frame ground	Plug thread
DIN EN 175301-803 A (DIN 43650 A), 4-pin				
Pt100 (Single element)			N.C.	1
			Pt100 11	2
			Pt100 12	3
			Frame ground	Grounding lug
4 ... 20 mA, 2-wire			+Vs	1
			Iout	2
			N.C.	3
			Frame ground	Grounding lug

### Ordering information

Ordering key - Configuration possibilities see website

Product	TE2	-	#	.	#	.	#	#	#	.	####	.	#
Sensor tip	TE2												
Not specified													
Standard response tip, Ø 6 mm													
Fast response tip, Ø 4 mm													
Fast response tip, Ø 3 mm													

## TE2

Compact RTD temperature sensor

TE2-#.###.###.0

### Ordering information

Ordering key - Configuration possibilities see website

	TE2	-	#	.	#	.	#	#	#	#	.	####	.	#
<b>Process Connection</b>														
Tube without connection														1
G 1/2 A ISO 228-1 (G06)														3
G 1/2 A hygienic (A03)														4
M12 × 1.5 hygienic (A02)														5
M12 × 1.5 hygienic, PEEK cone, sensor tip Ø 3x5 mm (A02)														6
G1/8 ISO 228/1 female thread, Hygienic (A01)														7
G 1/4 A DIN 3852-E, with NBR seal (G50)														8
ISO 2852 (Tri-Clamp), DN 25; 33.7; 38, Ø 50.5 (C04)														9
DIN 32676-C (Tri-Clamp), DN 3/4, Ø 24.9 (C01)														A
BHC 3A DN 38 (B01)														B
1/2-14 NPT (N02)														D
1/4-18 NPT (N01)														E
G 1/2 A DIN 3852-E, with FKM seal (G51)														F
G 1/2 A DIN 3852-E, with EPDM seal (G51)														G
<b>Sensor element</b>														
1/1 B EN 60751, single														1
1/1 B EN 60751, duplex														2
1/3 B EN 60751, single														3
1/3 B EN 60751, duplex														4
1/6 B EN 60751, single														5
1/6 B EN 60751, duplex														6
1/1 A EN 60751, single														7
1/1 A EN 60751, duplex														8
<b>Cooling neck</b>														
Without cooling neck														0
With cooling neck														4
<b>Electrical connection</b>														
M12-A, 4-pin, stainless steel														1
M12-A, 4-pin, stainless steel, with integrated transmitter														2
DIN EN 175301-803 A (DIN 43650 A), 4-pin <sup>(1)</sup>														4
DIN EN 175301-803 A (DIN 43650 A), 4-pin, with integrated transmitter <sup>(1)</sup>														5
M12-A, 4-pin, stainless steel, with integrated transmitter, out pin 2+3														A
<b>Certificates</b>														
Not specified														0
Railway EN 50155														4
Ex ia Simple apparatus, gas and dust														9
<b>Sensor tube length (mm)</b>														
5 - 3000													####	
<b>Configuration</b>														
No configuration														0
Configuring according to customer specification														C

(1) Including female power connector