

VLXT-71M.I

Gigabit Ethernet, 7,0 Megapixel, Monochrome

Article number: 11700327

Overview

- 3200 × 2200 px
- Sony IMX420
- 1.1" CMOS
- 174 fps
- 10 GigE



Picture similar



GEN*i*CAM



Technical data

Sensor information

Sensor	Sony IMX420 Gen3
Mono/Color	Mono
Sensor type	1.1" CMOS
Shutter type	Global shutter
Resolution	3200 × 2200 px
Pixel size	4.5 × 4.5 μm
Exposure time	0.001 ... 60000 ms

Data quality (EMVA 1288 typical)

Dark noise	5.49 e-
Saturation capacity	24184 e-
Dynamic range	71.7 dB
Signal-to-noise ratio	43.8 dB
Quantum efficiency	72.9 % @ 536 nm

Acquisition formats

Image formats, interface frame rate max.	Full Frame, 3200 × 2200 px, max. 174 fps Binning 2×2, 1600 × 1100 px, max. 394 fps Binning 2×1, 1600 × 2200 px, max. 209 fps Binning 1×2, 3200 × 1100 px, max. 209 fps
--	---

Image formats, acquisition frame rate max. (Burst Mode)	Full Frame, 3200 × 2200 px, max. 209 fps
---	--

Acquisition formats

Pixel formats	Mono8 Mono10 Mono12 Mono12 Packed
---------------	--

Image preprocessing

Analog controls	Gain (0 ... 48 dB) Offset (0 ... 255 LSB 12 Bit)
-----------------	---

Color models	Mono
--------------	------

Camera features

Basic Functions	Exposure Gain / Color Gain Trigger / Exposure Active (Flash) Binning 2x2 Partial Scan Offset Free Running Mode (Live Image) Multi ROI
-----------------	--

Auto Functions	Exposure Auto Gain Auto
----------------	----------------------------

Image Pre-processing	Image Flipping (X/Y) LUT / Gamma High Dynamic Range (HDR) Shading Correction Edge Sharpening Noise Reduction
----------------------	---

VLXT-71M.I

Gigabit Ethernet, 7,0 Megapixel, Monochrome

Article number: 11700327

Technical data

Camera features

Acquisition / Interface	Burst Mode Adjustable Framerate Short Exposure Time Enable Device Link Throughput Limit Internal Image Buffer
Synchronization	free running trigger
Trigger sources	Hardware Software ActionCommand
Trigger delay	0 ... 2 sec, tracking and buffering of up to 256 trigger signals
Process Synchronization	Events Timer Trigger Delay Debouncer Counter Sequencer Trigger via Action CMD (GigE) Action CMD Request ID Trigger ID inside Chunk Additional Output Modes (e.g. Trigger Ready) PWM (PWM Duration / PWM Duty Cycle) Selectable Output format (e.g. Tri State, Push Pull) Chunk data inside transferred image Encoder support via Counter End trigger source 4 power outputs with up to 120 W (max. 48 V / 2.5 A)
Time synchronization IEEE 1588	IEEE 1588 / Master and Slave function IEEE 1588 / Scheduled Action CMD IEEE 1588 / Synchronized Acquisition Framerate
Additional Functions	User Set Integrated temperature sensor Readable additional information (e.g. sensor information) Save Custom Data
Lens control	Corning liquid lens
Sequencer	Automated control for series of images using different sets of parameters
Sequencer parameter	Exposure time gain factor output line ROI Offset x ROI Offset y

Camera features

Internal image buffer	1024 MB 78 images (Trigger Mode) 1 image (Free Running Mode)
-----------------------	--

Interfaces and connectors

Data interface	10 Gigabit Ethernet, Transfer rate 10000 Mbits/sec, Gigabit Ethernet, Transfer rate 1000 Mbits/sec, Fast Ethernet, Transfer rate 100 Mbits/sec, Connector: M12 / 8-pol x-coded (SACC-CI-M12FS-8CON-L180-10G)
Process interface	M12 / 12 pins a-coded (SACC-CI-M12MS-12CON-L180)
Power supply	via M12/12 pins a-coded

Mechanical data

Lens mount	C-mount
Width	60 mm
Height	60 mm
Depth	99.7 mm
Weight	≤ 485 g
Material	aluminum

Electrical data

Voltage supply range +Vs	19.2 ... 28.8 V DC (external power supply)
Power consumption	Approx. 12.2 W @ 24 VDC and 174 fps

Non-volatile memory

Flash memory size	128 kB
-------------------	--------

Environmental conditions

Operating temperature	0 ... +60 ° @ T = measurement point
Humidity	10 ... 90 % (non-condensing)
Protection class	IP 40 IP 54 (with mounted tube and cable) IP 65 (with mounted tube and cable) IP 67 (with mounted tube and cable)

Digital I/Os

Lines	2 input lines 4 power output lines with pulse width modulation (PWM) (max. 48 V / max. 2,5 A) RS232
-------	---

Conformity

Conformity	CE RoHS EAC KC (R-R-BkR-VLXT-71MI) UL recognized
------------	--

VLXT-71M.I

Gigabit Ethernet, 7,0 Megapixel, Monochrome

Article number: 11700327

Dimension drawing



Principle

Optional accessories for protection class IP 65/67:

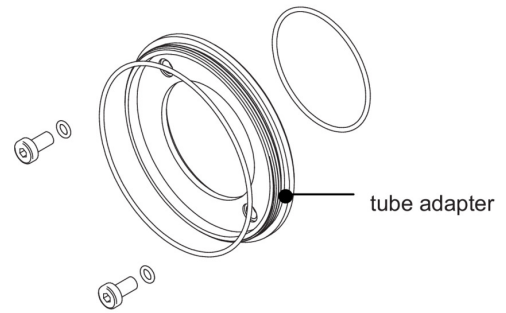

tube adapter

- hard-anodized, incl. sealing and screws
 \varnothing 49,5 mm (VCXG.I 11185373)
 \varnothing 65 mm (VCXG.I 11185377)
 \varnothing 95 mm (VCXG.I 11704311)
 \varnothing 65 mm (VLXT 11193125)
 \varnothing 95 mm (VLXT.EF 11704315)

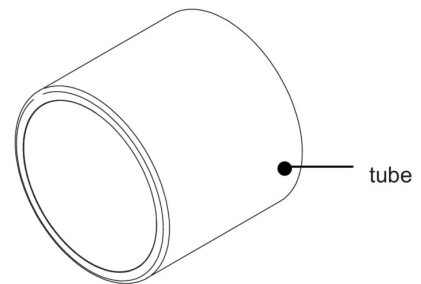

tube

- hard-anodized, cover glass PMMA
 \varnothing 49,5 mm, Length 44 mm (11185370)
 \varnothing 65 mm, Length 58 mm (11185374)
 \varnothing 95 mm, length 70 mm (11704312)
- hard-anodized, tempered laminated safety glass
 \varnothing 49,5 mm, Length 44 mm (11701124)
 \varnothing 65 mm, Length 58 mm (11701125)