

IDC – The multicode reader series

Simply code and text reading - Designed by Baumer

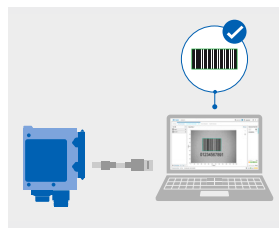

Easy commissioning and integration
Parameterization with intuitive web interface and auto setup



High reading rate
Reading / decoding of every conventional 1D / 2D code as well as text



Fast and flexible
Reading multiple codes and lines of text with up to 40 frames per second

Smart functions in a compact device



Display

- OLED display showing IP address, result, code type and class (1D / 2D), text, selected job etc.
- Four RGB LED indicators, visible from all around



Internal and external illumination

- LED ring with four individually switchable segments
- Solving even most challenging applications by synchronization of external illumination



Comprehensive range of accessories

- Polarizing filter to eliminate reflections
- Smart mounting system with base bracket for all common industrial profiles
- Bar mount onto bars (12 to 16 mm)
- Optional: cooling element

	IDC2xx.W06	IDC2xx.W08	IDC2xx.W16
Reading distance	50 ... 1000 mm	50 ... 1000 mm	100 ... 1000 mm
Field of view min.	41 x 25 mm	29 x 18 mm	23 x 14 mm
Field of view max.	649 x 405 mm	485 x 303 mm	240 x 150 mm
Min. module size (1D / 2D)	0.05 / 0.1 mm	0.04 / 0.07 mm	0.03 / 0.06 mm
Decoding rate max.	40 codes per second at 1 MP		
Protocols	PROFINET (CC-A) / Ethernet-IP / TCP / FTP / SFTP / USB-HID		

Description	Order No.
Polarisation filter with snap function (size 44 mm)	11704588
Head sink for high ambient temperature environment	11720395
Clamping jaws for rod mount	11720396
Mounting bracket 90°	11720397
Cable (different variants)	See product page

